



## Birch Crescent, Brandon, IP27 9JR

**Rent - Asking Price £300,000      Deposit -**

Situated in a quiet cul-de-sac location, this well-presented detached bungalow offers a very generous garden, comfortable and well-proportioned accommodation, ideal for those seeking peaceful single-level living.

The property comprises three good-sized bedrooms and a spacious living room, providing a bright and welcoming space to relax and entertain. Additional features include a garage, offering secure parking or useful storage.

- DETACHED BUNGALOW
- LARGE PRIVATE GARDEN
- SINGLE GARAGE
- IDEAL LOCATION
- SPACIOUS LIVING ROOM
- MODERN KITCHEN
- SPACIOUS LOUNGE
- DRIVEWAY
- THREE BEDROOMS
- CALL SHIRES TO VIEW



Council Tax Band: B - EPC Rating: E 47



Approx Gross Internal Area  
79 sq m / 845 sq ft

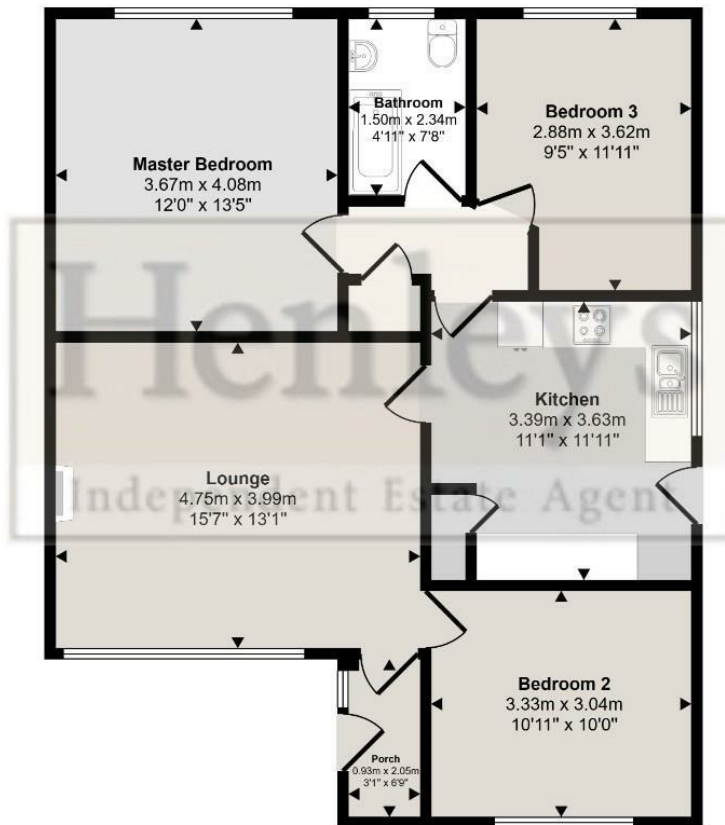

Floorplan

This floorplan is only for illustrative purposes and is not to scale. Measurements of rooms, doors, windows, and any items are approximate and no responsibility is taken for any error, omission or mis-statement. Icons of items such as bathroom suites are representations only and may not look like the real items. Made with Made Snappy 360.

